



[DBPR HOME](#) | [ABOUT DBPR](#) | [DBPR DIVISIONS](#) | [CONTACT DBPR](#)

[BCIS Home](#) | [Log In](#) | [User Registration](#) | [Hot Topics](#) | [Submit Surcharge](#) | [Stats & Facts](#) | [Publications](#) | [Contact Us](#) | [BCIS Site Map](#) | [Links](#) | [Search](#)



Product Approval
USER: Public User

[Product Approval Menu](#) > [Product or Application Search](#) > [Application List](#) > **Application Detail**

OFFICE OF THE SECRETARY

FL #	FL26942-R5												
Application Type	Revision												
Code Version	2023												
Application Status	Approved												
Comments													
Archived	<input type="checkbox"/>												
Product Manufacturer	Mr-Glass Doors & Windows Manufacturing, LLC												
Address/Phone/Email	8051 NW 79th Place Medley, FL 33166 (305) 470-8284 ulises@mrglasswindows.com												
Authorized Signature	Ulises Senaris ulises@mrglasswindows.com												
Technical Representative	Augusto Arias												
Address/Phone/Email	8120 NW 84th St Medley, FL 33166 (305) 470-8284 aarias@mrglasswindows.com												
Quality Assurance Representative													
Address/Phone/Email													
Category	Exterior Doors												
Subcategory	Swinging Exterior Door Assemblies												
Compliance Method	Evaluation Report from a Florida Registered Architect or a Licensed Florida Professional Engineer <input type="checkbox"/> Evaluation Report - Hardcopy Received												
Florida Engineer or Architect Name who developed the Evaluation Report	Jalal Farooq												
Florida License	PE-81223												
Quality Assurance Entity	Keystone Certifications, Inc.												
Quality Assurance Contract Expiration Date	08/27/2025												
Validated By	Abel Carrasco, PE <input checked="" type="checkbox"/> Validation Checklist - Hardcopy Received												
Certificate of Independence	FL26942_R5_COI_SS - Certificate of Independence 2023.pdf												
Referenced Standard and Year (of Standard)	<table border="0"> <thead> <tr> <th>Standard</th> <th>Year</th> </tr> </thead> <tbody> <tr> <td>ASTM E1886</td> <td>2013</td> </tr> <tr> <td>ASTM E1996</td> <td>2014</td> </tr> <tr> <td>TAS-201</td> <td>1994</td> </tr> <tr> <td>TAS-202</td> <td>1994</td> </tr> <tr> <td>TAS-203</td> <td>1994</td> </tr> </tbody> </table>	Standard	Year	ASTM E1886	2013	ASTM E1996	2014	TAS-201	1994	TAS-202	1994	TAS-203	1994
Standard	Year												
ASTM E1886	2013												
ASTM E1996	2014												
TAS-201	1994												
TAS-202	1994												
TAS-203	1994												
Equivalence of Product Standards Certified By													

Sections from the Code

Product Approval Method Method 1 Option D

Date Submitted 08/15/2023

Date Validated 08/17/2023

Date Pending FBC Approval 08/19/2023

Date Approved 10/17/2023

Summary of Products

FL #	Model, Number or Name	Description
26942.1	Series 3000 Aluminum Outswing Entrance Door	Large missile impact resistant aluminum outswing entrance door.
Limits of Use Approved for use in HVHZ: Yes Approved for use outside HVHZ: Yes Impact Resistant: Yes Design Pressure: +80/-80 Other: See drawing 18-36F for span vs load combinations and installation details.		Installation Instructions FL26942_R5_II_SS - MG 3000 Alum OS Door (LMI) - DWG 18-36F 2023.pdf Verified By: Jalal Farooq PE # 81223 Created by Independent Third Party: Yes Evaluation Reports FL26942_R5_AE_SS - MG 3000 Alum OS Door (LMI) - PAE 2023.pdf Created by Independent Third Party: Yes
26942.2	Series MG3500 Residential Outswing Entry Door	Large missile impact resistant aluminum outswing entrance door
Limits of Use Approved for use in HVHZ: Yes Approved for use outside HVHZ: Yes Impact Resistant: Yes Design Pressure: +80/-80 Other: See drawing 23-29F for span vs load combinations and installation details		Installation Instructions FL26942_R5_II_SS - MG 3500 Resd Entry Door (LMI) - DWG 23-29F 2023.pdf Verified By: Jalal Farooq PE # 81223 Created by Independent Third Party: Yes Evaluation Reports FL26942_R5_AE_SS - MG 3500 Resd Entry Door (LMI) - PAE 2023.pdf Created by Independent Third Party: Yes

[Back](#) [Next](#)

Contact Us :: 2601 Blair Stone Road, Tallahassee FL 32399 Phone: 850-487-1824

The State of Florida is an AA/EEO employer. [Copyright 2007-2013 State of Florida.](#) :: [Privacy Statement](#) :: [Accessibility Statement](#) :: [Refund Statement](#)

Under Florida law, email addresses are public records. If you do not want your e-mail address released in response to a public-records request, do not send electronic mail to this entity. Instead, contact the office by phone or by traditional mail. If you have any questions, please contact 850.487.1395. *Pursuant to Section 455.275(1), Florida Statutes, effective October 1, 2012, licensees licensed under Chapter 455, F.S. must provide the Department with an email address if they have one. The emails provided may be used for official communication with the licensee. However email addresses are public record. If you do not wish to supply a personal address, please provide the Department with an email address which can be made available to the public. To determine if you are a licensee under Chapter 455, F.S., please click [here](#).

Product Approval Accepts:



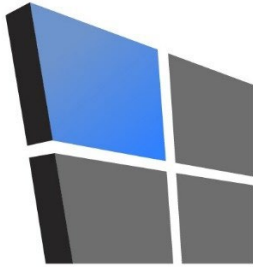

AL-FAROOQ CORPORATION

CONSULTING ENGINEERS & PRODUCT DEVELOPMENT

January 23, 2023

Product Approval Administrator
Building Codes & Standards Section
Department of Business & Professional Regulations
1940 North Monroe Street, Suite 90
Tallahassee, FL 32399-2100

To whom it may concern,

As the design engineer retained to prepare the product approval(s) associated with this letter as shown below on this same web page, I do hereby declare that I do not have and will not have any financial interest in any company manufacturing or distributing the referenced product(s), nor do I have or will have any financial interest with any other entity involved in the approval process of the referenced product(s).

Sincerely,



Jalal Farooq, P.E.
CFO

Sealed: 1/23/2023

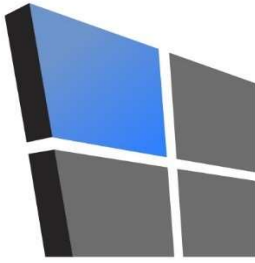

AL-FAROOQ CORPORATION

CONSULTING ENGINEERS & PRODUCT DEVELOPMENT

PRODUCT APPROVAL EVALUATION RULE CHAPTER #61G20-3 • METHOD 1 OPTION D

FL 26942

Date: 07/24/2023

Detailed Product Description:

Manufacturer: MR-GLASS DOORS & WINDOWS MANUFACTURING, LLC.

Manufacturer Address: 8051 NW 79th PLACE, MEDLEY, FL 33166

Model Name: SERIES MG3500 RESIDENTIAL OUTSWING ENTRY DOOR

Maximum Load: +80 PSF, -80 PSF (Large Missile Impact)

Installation Drawings # 23-29F

This product complies with the High Velocity Hurricane Zone (HVHZ) testing requirements.					
For maximum sizes, combination of span vs loads and anchor type refer to installation drawings.					
Comparative analysis used <input checked="" type="checkbox"/> Yes <input type="checkbox"/> No					
Mandatory Tests (Tested in accordance with AAMA 101/I.S.2/NAFS/TAS-202)					
Test	Description	Test Location	Test Report Date	Test Report #	Test Sealed By
ASTM E283	Air Infiltration Leakage	Hurricane Engineering & Testing, Inc	2/13/2018	HETI-18-6004	Rafael E. Droz-Seda, P.E.
			2/13/2018	HETI-18-6011	
			10/29/2021	HETI-21-7089	Ram N. Tewari, P.E.
			3/13/2023	HETI-23-8014	
			3/13/2023	HETI-23-8016	
5/26/2023	HETI-23-8024				
ASTM E331 OR ASTM 547 & TAS 202	Water Penetration	Hurricane Engineering & Testing, Inc	2/13/2018	HETI-18-6002	Rafael E. Droz-Seda, P.E.
			2/13/2018	HETI-18-6004	
			2/13/2018	HETI-18-6011	
			10/29/2021	HETI-21-7089	Ram N. Tewari, P.E.
			3/13/2023	HETI-23-8014	
3/13/2023	HETI-23-8016				
5/26/2023	HETI-23-8024				
ASTM E330 & TAS 202	Uniform Static Air Press.	Hurricane Engineering & Testing, Inc	2/13/2018	HETI-18-6001	Rafael E. Droz-Seda, P.E.
			2/13/2018	HETI-18-6002	
			2/13/2018	HETI-18-6004	
			2/13/2018	HETI-18-6011	
			10/29/2021	HETI-21-7089	Ram N. Tewari, P.E.
			10/19/2021	HETI-21-7086	
			3/13/2023	HETI-23-8014	
3/13/2023	HETI-23-8016				
5/26/2023	HETI-23-8024				

ASTM 1304	Forced Entry Test	Hurricane Engineering & Testing, Inc	2/13/2018	HETI-18-6001	Rafael E. Droz-Seda, P.E.
			2/13/2018	HETI-18-6002	
			2/13/2018	HETI-18-6004	
			2/13/2018	HETI-18-6011	
			10/29/2021	HETI-21-7089	Ram N. Tewari, P.E.
			10/19/2021	HETI-21-7086	
			3/13/2023	HETI-23-8014	
			3/13/2023	HETI-23-8016	
5/26/2023	HETI-23-8024				

Supplemental Tests (Tested in accordance with TAS-201 and TAS-203)

Test	Description	Test Location	Test Report Date	Test Report#	Test Sealed By
FBC 1626.2 (TAS 201 & 203) ASTM E1886 & E1996	Large Missile Impact & Cyclic	Hurricane Engineering & Testing, Inc	2/13/2018	HETI-18-6003	Rafael E. Droz-Seda, P.E.
			2/13/2018	HETI-18-6005	
			2/13/2018	HETI-18-6012	
			10/29/2021	HETI-21-7089	Ram N. Tewari, P.E.
			10/19/2021	HETI-21-7086	
			3/13/2023	HETI-23-8014	
			3/13/2023	HETI-23-8016	
			5/26/2023	HETI-23-8024	

Under the limitations of the attached installation drawings, to the best of my knowledge and ability, the above product conforms to the requirements of the 2023 Florida Building Code.

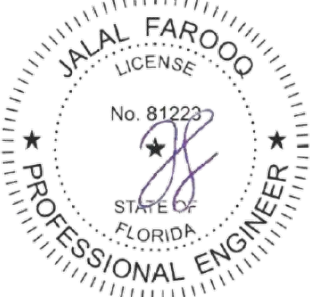
<p>Evaluation Report Engineer:</p> <p>Jalal Farooq Al-Farooq Corporation</p> <p align="right">PE # 81223 EB # 3538</p>	<div align="center">  <p>Sealed: 7/27/2023</p> </div>
--	---

THESE DOORS ARE RATED FOR LARGE & SMALL MISSILE IMPACT. SHUTTERS ARE NOT REQUIRED.

**MG3500
RESIDENTIAL OUTSWING ENTRY DOOR**

DESIGN LOAD CAPACITY OF SINGLE (X) AND DOUBLE (XX) LEAF DOORS SEE SHEET 2.

DOORS CAN ALSO BE USED WITH 'MR. GLASS' SERIES MG3000 SIDELITES, SEE SEPARATE APPROVAL FOR SDIELITE AND SIDELITE MULLION CAPACITY.

LOWER VALUES FROM DOOR CAPACITY, SIDELITE CAPACITY OR SIDELITE MULLION CAPACITY WILL APPLY TO ENTIRE SYSTEM.

DOORS APPROVED FOR INSTALLATION WHERE WATER INFILTRATION RESISTANCE IS REQUIRED.

THIS PRODUCT HAS BEEN DESIGNED AND TESTED TO COMPLY WITH THE REQUIREMENTS OF THE 2020 (7TH EDITION)/2023 (8TH EDITION) FLORIDA BUILDING CODE INCLUDING HIGH VELOCITY HURRICANE ZONE (HVHZ).

1BY OR 2BY WOOD BUCKS & BUCK FASTENERS BY OTHERS, MUST BE DESIGNED AND INSTALLED ADEQUATELY TO TRANSFER APPLIED PRODUCT LOADS TO THE BUILDING STRUCTURE.

ANCHORS SHALL BE CORROSION RESISTANT, SPACED AS SHOWN ON DETAILS AND INSTALLED PER MANUF'S INSTRUCTIONS. SPECIFIED EMBEDMENT TO BASE MATERIAL SHALL BE BEYOND WALL DRESSING OR STUCCO.

A LOAD DURATION INCREASE IS USED IN DESIGN OF ANCHORS INTO WOOD ONLY.

ALL SHIMS TO BE HIGH IMPACT, NON-METALLIC AND NON-COMPRESSIBLE.

MATERIALS INCLUDING BUT NOT LIMITED TO STEEL/METAL SCREWS, THAT COME INTO CONTACT WITH OTHER DISSIMILAR MATERIALS SHALL MEET THE REQUIREMENTS OF THE 2020/2023 FLORIDA BLDG. CODE & ADOPTED STANDARDS.

THIS PRODUCT APPROVAL IS GENERIC AND DOES NOT PROVIDE INFORMATION FOR A SITE SPECIFIC PROJECT, i.e. LIFE SAFETY OF THIS PRODUCT, ADEQUACY OF STRUCTURE RECEIVING THIS PRODUCT AND SEALING AROUND OPENING FOR WATER INFILTRATION RESISTANCE ETC. CONDITIONS NOT SHOWN IN THIS DRAWING ARE TO BE ANALYZED SEPARATELY, AND TO BE REVIEWED BY BUILDING OFFICIAL.

DESIGN LOADS SHOWN ARE BASED ON 'ALLOWABLE STRESS DESIGN (ASD)'.

MANUFACTURER'S LABEL SHALL BE LOCATED ON A READILY VISIBLE LOCATION IN ACCORDANCE WITH SECTION 1709.9.3 OF FLORIDA BUILDING CODE. LABELING TO COMPLY WITH SECTION 1709.9.2.

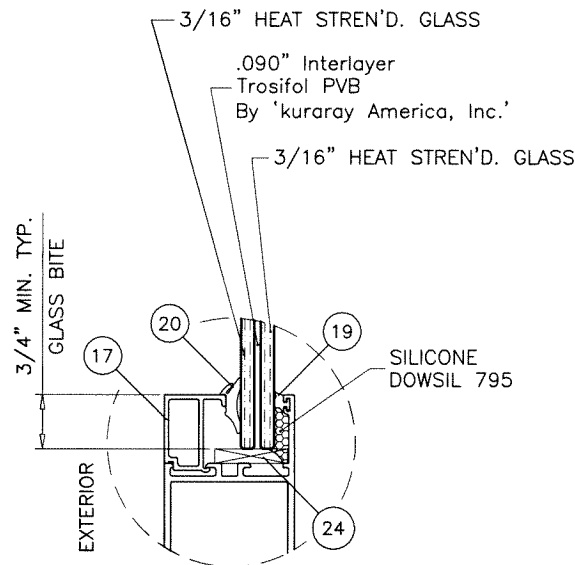

GLASS TYPE 'A'

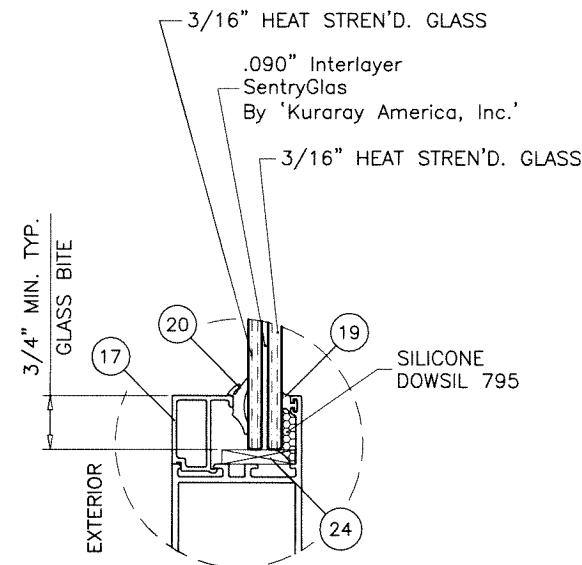

GLASS TYPE 'B'

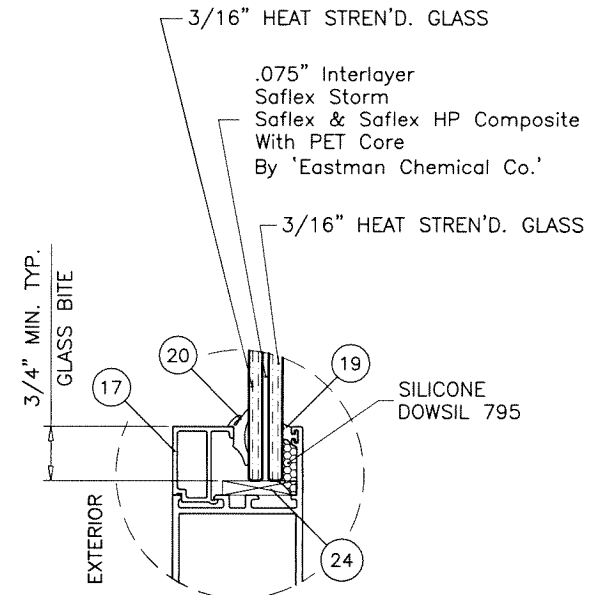

GLASS TYPE 'C'

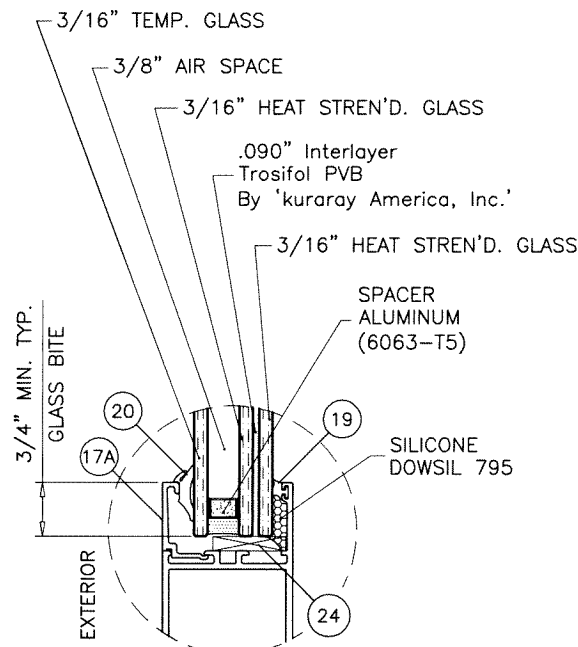

GLASS TYPE 'Ai'

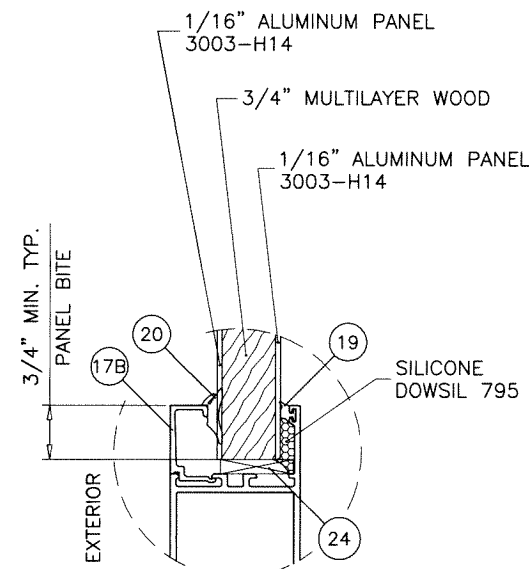

7/8" OVERALL GLUED CLADDED PANEL

EXTERIOR AND INTERIOR ALUMINUM CLADDING GLUED TO CENTER CORE WITH MRG-A-30-013

Sealed: 7/27/2023

FL #26942

A- CONTRACTOR TO BE RESPONSIBLE FOR THE SELECTION, PURCHASE AND INSTALLATION OF THIS PRODUCT BASED ON THIS PRODUCT EVALUATION PROVIDED HE/SHE DOES NOT DEVIATE FROM THE CONDITIONS DETAILED ON THIS DOCUMENT.
 B- THIS PRODUCT EVALUATION DOCUMENT WILL BE CONSIDERED INVALID IF ALTERED BY ANY MEANS.
 C- SITE SPECIFIC PROJECTS SHALL BE PREPARED BY A FLORIDA REGISTERED ENGINEER OR ARCHITECT WHICH WILL BECOME THE ENGINEER OF RECORD (E.O.R.) FOR THE PROJECT AND WHO WILL BE RESPONSIBLE FOR THE PROPER USE OF THE P.E.D. ENGINEER OF RECORD, ACTING AS A DELEGATED ENGINEER TO THE P.E.D. ENGINEER SHALL SUBMIT TO THIS LATTER THE SITE SPECIFIC DRAWINGS FOR REVIEW.
 D- THIS P.E.D. SHALL BEAR THE DATE AND ORIGINAL SEAL AND SIGNATURE OF THE PROFESSIONAL ENGINEER OF RECORD THAT PREPARED IT.

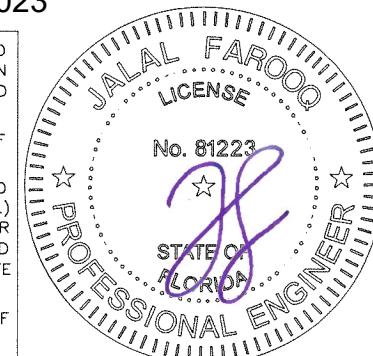

af c
AL-FAROOQ CORPORATION
 ENGINEERS & PRODUCT DEVELOPMENT
 9360 SUNSET DRIVE, SUITE 220
 MIAMI, FLORIDA 33173
 TEL. (305) 264-8100 FAX. (305) 262-6978
 (C.A.N. 3538)
 COMP-ANL\23-29F-MG

MG3500 RESIDENTIAL OUTSWING DOOR (L.M.I.)
MR-GLASS DOORS & WINDOWS MANUFACTURING, LLC
 8051 N.W. 79th Place
 Medley, FL. 33166
 Tel. (305) 764-3963 Fax. (305) 470-8285

no	date	description	by
A	07.18.23	UPDATED TO 2023 FBC	
date:	06-26-23	scale:	3/8" = 1"
dr. by:	TARIQ	chk. by:	
drawing no.		23-29F	
sheet		1 of 7	

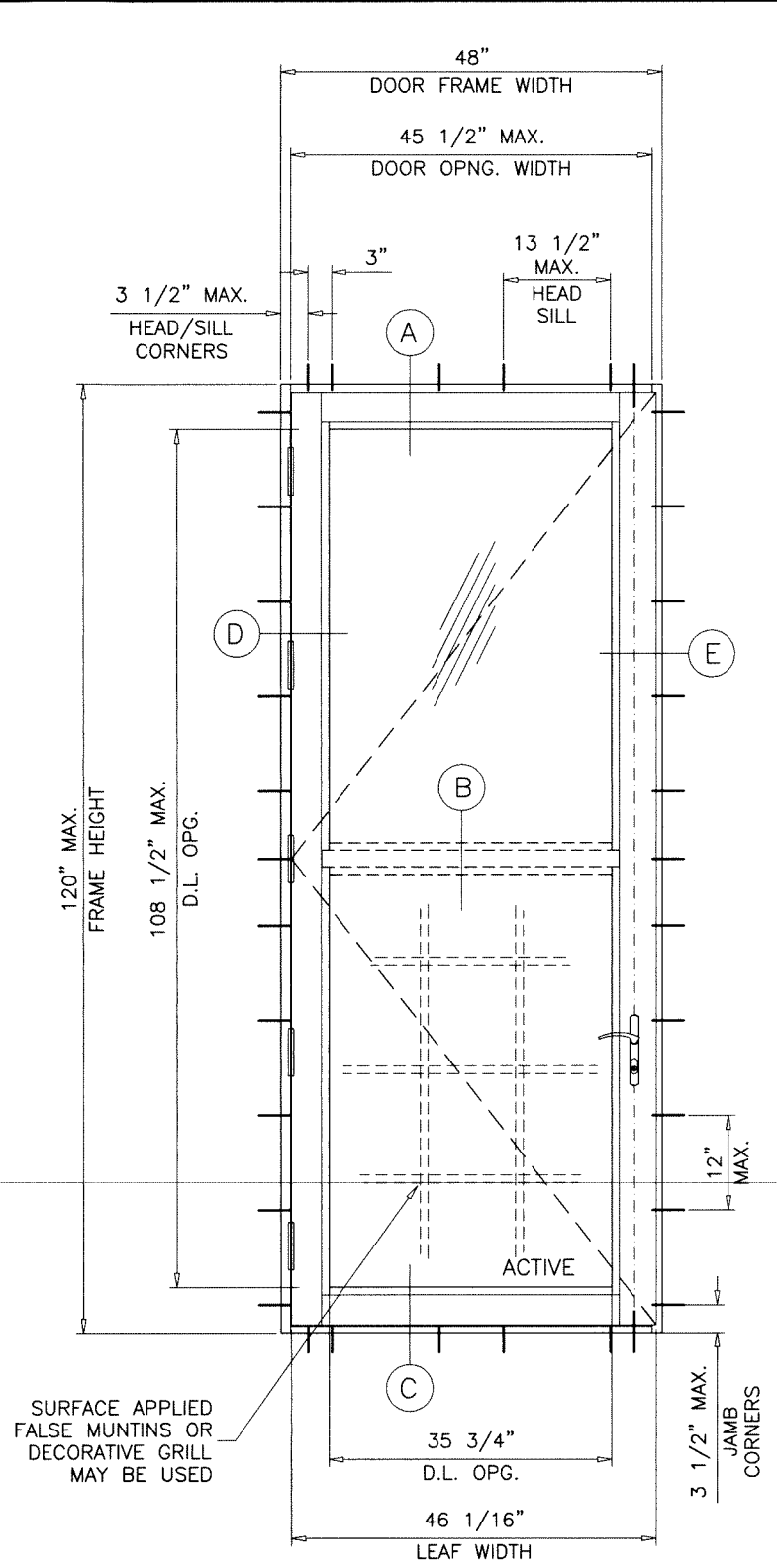

TYPICAL ELEVATION
(X)

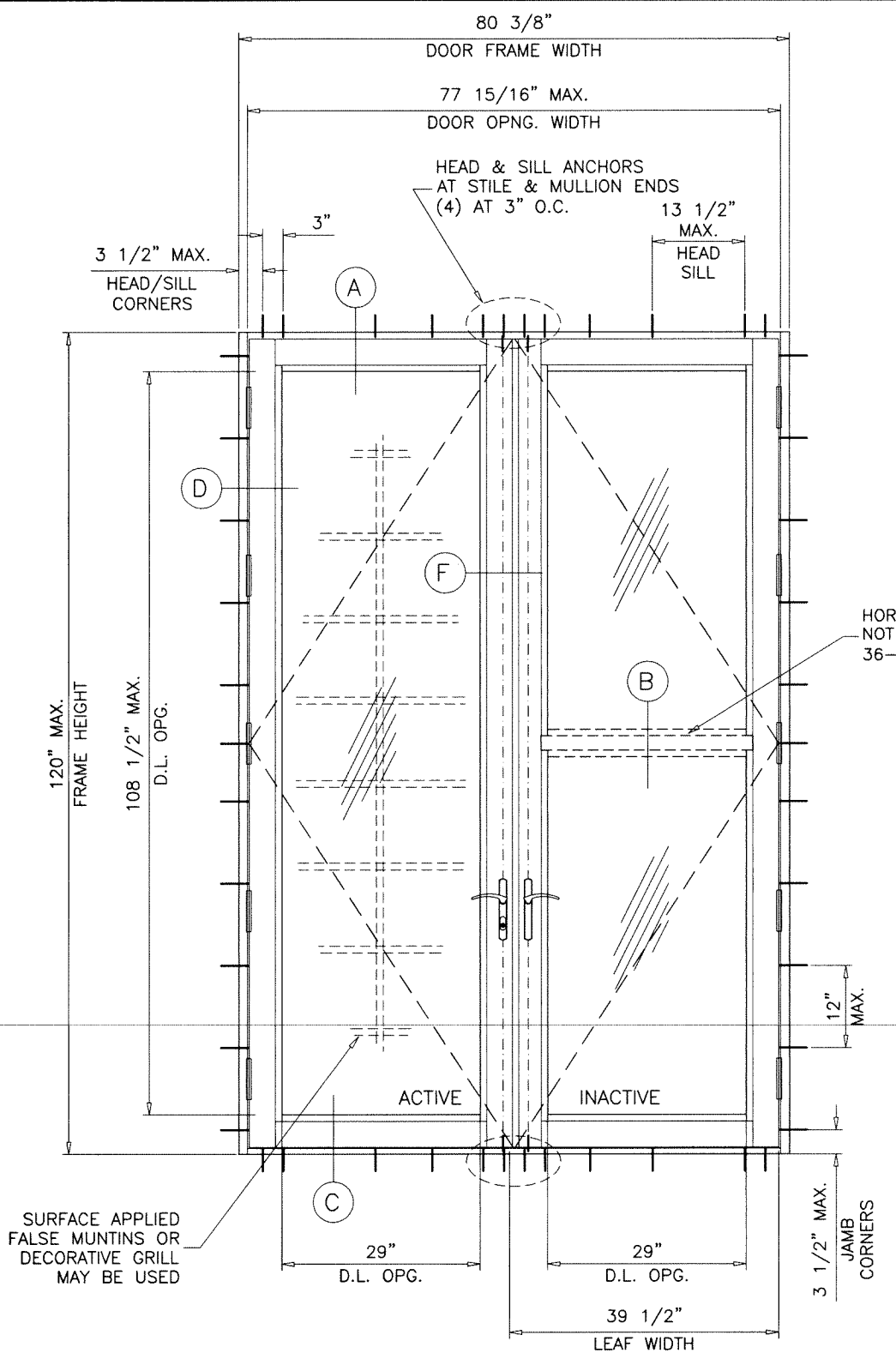

TYPICAL ELEVATION
(XX)

NOTE:
EGRESS REQUIREMENTS TO BE REVIEWED
BY BUILDING OFFICIAL.

GLASS D.L.O. FORMULAE:
D.L.O. WIDTH = FRAME WIDTH - 12.438" (X DOORS)
= (FRAME WIDTH - 22.0")/2 (XX DOORS)
D.L.O. HEIGHT = FRAME HEIGHT - 11.50"

NOTE:
GLASS CAPACITIES ON THIS SHEET ARE
BASED ON ASTM E1300-09 (3 SEC. GUSTS)
AND FLORIDA BUILDING COMMISSION
DECLARATORY STATEMENT DCA05-DEC-219

Sealed: 7/27/2023

DOORS LOAD CAPACITY - PSF SINGLE (X) DOORS									
SINGLE DOOR (X) DIMS.		GLASS						GLUED CLADDED PANEL	
FRAME WIDTH	FRAME HEIGHT	TYPE 'A' & 'Ai'		TYPE 'B'		TYPE 'C'		EXT.(+)	INT.(-)
40-1/2"	98"	EXT.(+)	INT.(-)	EXT.(+)	INT.(-)	EXT.(+)	INT.(-)	80.0	80.0
41-3/8"	120"	-	-	65.0	70.0	60.0	60.0	80.0	80.0
48"	120"	-	-	65.0	70.0	60.0	60.0	80.0	80.0

DOORS LOAD CAPACITY - PSF DOUBLE (XX) DOORS									
DOUBLE DOOR (XX) DIMS.		GLASS						GLUED CLADDED PANEL	
FRAME WIDTH	FRAME HEIGHT	TYPE 'A' & 'Ai'		TYPE 'B'		TYPE 'C'		EXT.(+)	INT.(-)
78-1/2"	98"	EXT.(+)	INT.(-)	EXT.(+)	INT.(-)	EXT.(+)	INT.(-)	80.0	80.0
80-3/8"	120"	-	-	-	-	60.0	60.0	60.0	60.0

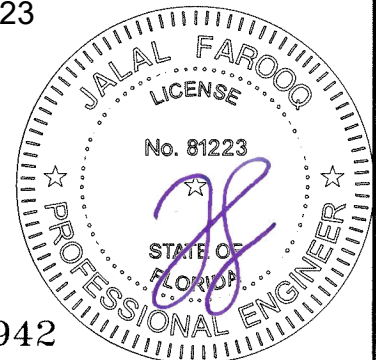

FL #26942

af c
AL-FAROOQ CORPORATION
ENGINEERS & PRODUCT DEVELOPMENT
9360 SUNSET DRIVE, SUITE 220
MIAMI, FLORIDA 33173 (C.A.N. 3538)
TEL. (305) 264-8100 FAX. (305) 262-6978
COMP-ANL\23-29F-MG

MG3500 RESIDENTIAL OUTSWING DOOR (L.M.I.)
MR-GLASS DOORS & WINDOWS MANUFACTURING, LLC
8051 N.W. 79th Place
Medley, FL 33166
Tel. (305) 764-3963 Fax. (305) 470-8285

revisions:	no	date	description
date:	06-26-23	scale:	1/2"=1'-0"
dr. by:	TARIQ	chk. by:	
drawing no.	23-29F		
sheet	2 of 7		

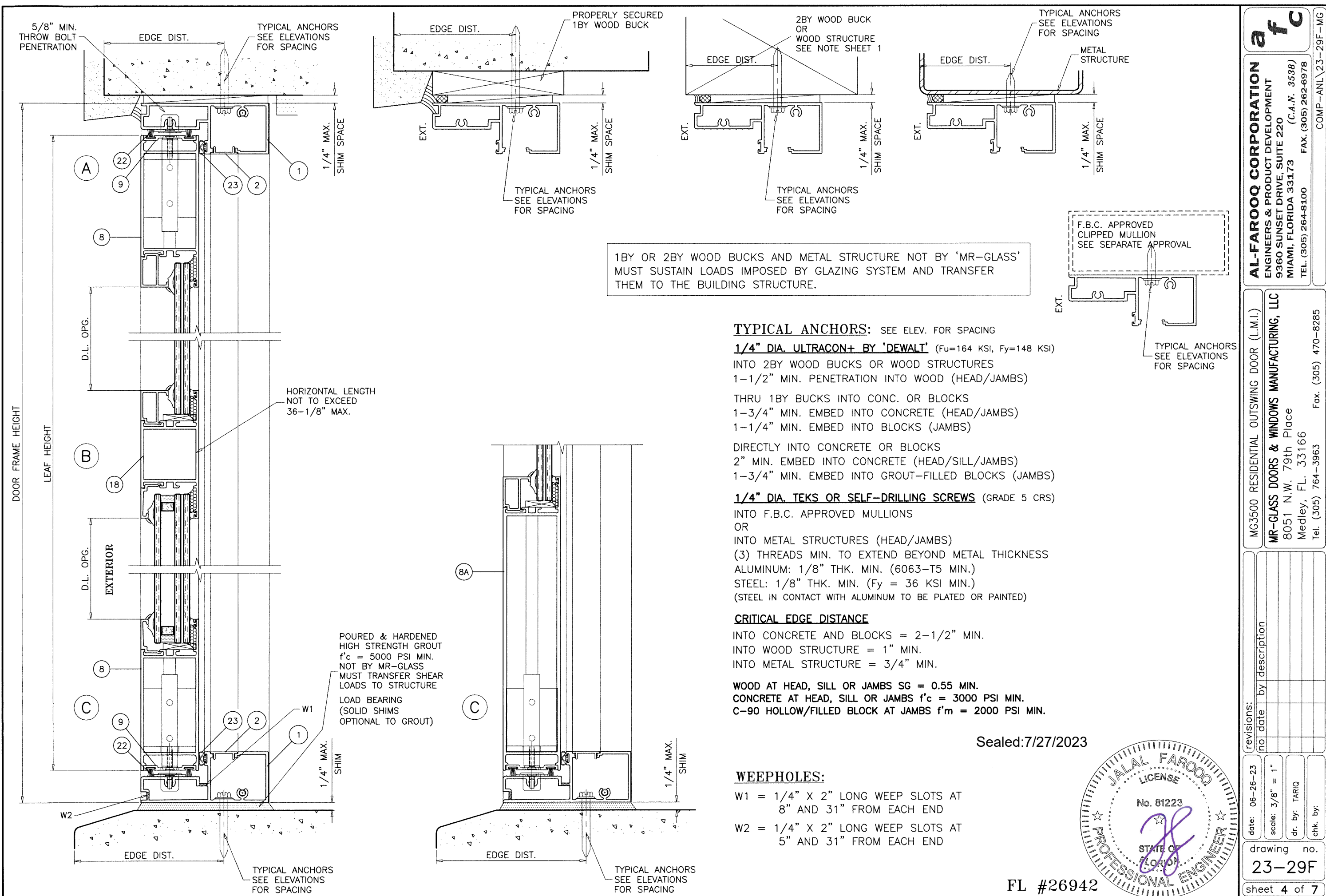

1BY OR 2BY WOOD BUCKS AND METAL STRUCTURE NOT BY 'MR-GLASS' MUST SUSTAIN LOADS IMPOSED BY GLAZING SYSTEM AND TRANSFER THEM TO THE BUILDING STRUCTURE.

TYPICAL ANCHORS: SEE ELEV. FOR SPACING
1/4" DIA. ULTRACON+ BY 'DEWALT' (Fu=164 KSI, Fy=148 KSI)
 INTO 2BY WOOD BUCKS OR WOOD STRUCTURES
 1-1/2" MIN. PENETRATION INTO WOOD (HEAD/JAMBS)
 THRU 1BY BUCKS INTO CONC. OR BLOCKS
 1-3/4" MIN. EMBED INTO CONCRETE (HEAD/JAMBS)
 1-1/4" MIN. EMBED INTO BLOCKS (JAMBS)
 DIRECTLY INTO CONCRETE OR BLOCKS
 2" MIN. EMBED INTO CONCRETE (HEAD/SILL/JAMBS)
 1-3/4" MIN. EMBED INTO GROUT-FILLED BLOCKS (JAMBS)
1/4" DIA. TEKS OR SELF-DRILLING SCREWS (GRADE 5 CRS)
 INTO F.B.C. APPROVED MULLIONS
 OR
 INTO METAL STRUCTURES (HEAD/JAMBS)
 (3) THREADS MIN. TO EXTEND BEYOND METAL THICKNESS
 ALUMINUM: 1/8" THK. MIN. (6063-T5 MIN.)
 STEEL: 1/8" THK. MIN. (Fy = 36 KSI MIN.)
 (STEEL IN CONTACT WITH ALUMINUM TO BE PLATED OR PAINTED)
CRITICAL EDGE DISTANCE
 INTO CONCRETE AND BLOCKS = 2-1/2" MIN.
 INTO WOOD STRUCTURE = 1" MIN.
 INTO METAL STRUCTURE = 3/4" MIN.
 WOOD AT HEAD, SILL OR JAMBS SG = 0.55 MIN.
 CONCRETE AT HEAD, SILL OR JAMBS f'c = 3000 PSI MIN.
 C-90 HOLLOW/FILLED BLOCK AT JAMBS f'm = 2000 PSI MIN.

Sealed:7/27/2023

WEEPHOLES:
 W1 = 1/4" X 2" LONG WEEP SLOTS AT 8" AND 31" FROM EACH END
 W2 = 1/4" X 2" LONG WEEP SLOTS AT 5" AND 31" FROM EACH END

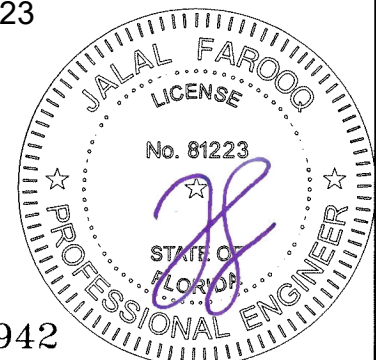

FL #26942

af c
AL-FAROOQ CORPORATION
 ENGINEERS & PRODUCT DEVELOPMENT
 9360 SUNSET DRIVE, SUITE 220
 MIAMI, FLORIDA 33173 (C.A.N. 3538)
 TEL. (305) 264-8100 FAX. (305) 262-6978
 COMP-ANL\23-29F-MG

MG3500 RESIDENTIAL OUTSWING DOOR (L.M.I.)
MR-GLASS DOORS & WINDOWS MANUFACTURING, LLC
 8051 N.W. 79th Place
 Medley, FL. 33166
 Tel. (305) 764-3963 Fax. (305) 470-8285

revisions:	no	date	by	description
date:	06-26-23	scale:	3/8" = 1"	
dr. by:	TARIQ	chk. by:		
drawing no.	23-29F			
sheet	4 of 7			

ITEM #	PART #	REQD.	DESCRIPTION	MATERIAL	MANF./SUPPLIER/REMARKS
1	E3008	AS REQD.	DOOR FRAME HEAD/SILL	6063-T6	-
2	E1018	AS REQD.	FRAME COVER	6063-T6	-
3	E3006	AS REQD.	DOOR FRAME JAMB	6063-T6	-
8	E3001	AS REQD.	LEAF TOP & BOTTOM RAIL	6063-T6	-
8A	E3020	AS REQD.	HIGH BOTTOM RAIL	6063-T6	-
9	E3005	AS REQD.	LEAF W'STRIP ADAPTER	6063-T6	-
10	E3002	AS REQD.	HINGE STILE	6063-T6	-
11	E3024	AS REQD.	LOCK STILE	6063-T6	-
12	E3023	AS REQD.	ASTRAGAL STILE	6063-T6	-
13	E3014	AS REQD.	SNAP COVER	6063-T5	-
15	E3015	AS REQD.	SHEAR BLOCK	6063-T6	3" LONG
15A	E3019	AS REQD.	SHEAR BLOCK	6063-T6	3" LONG
16	E3016	AS REQD.	SHEAR BLOCK NUT	6063-T6	3" LONG
16A	E3016	2/ HINGE	HINGE BACK-UP PLATE	6063-T6	8-1/2" LONG @ FRAME, 4-3/4" LONG @ LEAF
17	E9001	AS REQD.	GLAZING BEAD (LAM. GLASS)	6063-T6	-
17A	E9002	AS REQD.	GLAZING BEAD (INSUL. LAM. GLASS)	6063-T6	-
17B	E9003	AS REQD.	GLAZING BEAD (CLADDED PANEL)	6063-T6	-
18	E3012	AS REQD.	INTERMEDIATE HORIZONTAL	6063-T6	-
19	G30-01	AS REQD.	INTERIOR GLAZING SPACER	SANTOPRENE	DUROMETER 70±5 SHORE A
20	G10-04	AS REQD.	EXTERIOR GLAZING GASKET	SANTOPRENE	DUROMETER 70±5 SHORE A
21	G30-02	AS REQD.	DOUBLE FIN AIR SEAL W'STRIPPING	SANTOPRENE	DUROMETER 70±5 SHORE A
22	W71325NK	AS REQD.	PILE W'STRIPPING	WOOL	ULTRAFAB
23	G10-05	AS REQD.	BULB W'STRIPPING	SANTOPRENE	EPDM
24	-	2/ LITE	SETTING BLOCK, 1/8" X 1" X 4" LONG	EPDM	AT 6" FROM EACH END, DUROMETER 80±5
26	#12 X 1-1/2"	AS REQD.	FRAME ASSEMBLY SCREWS	ST. STEEL	HWH SMS
27	3/8 X 1"	AS REQD.	SHEAR BLOCK FASTENERS	ST. STEEL	HEX SOCKET HEAD SCREWS
28	#12 X 1-1/2"	AS REQD.	SHEAR BLOCK FASTENERS	ST. STEEL	HWH SMS

LOCKS:

ACTIVE LEAF:

MULTI POINT LOCK ASSEMBLY DL01-6065 BY 'INTERLOCK USA INC.'
 (3) LOCKING POINTS ENGAGING AT JAMB STRIKE PLATE
 LOCATED AT 22", 39" AND 54-1/2" FROM BOTTOM
 1/2" DIA. BOLTS WITH 5/8" THROW
 (1) AT TOP ENGAGING FRAME HEAD AND
 (1) AT BOTTOM ENGAGING FRAME SILL
 THROW BOLTS ATTACHED TO LOCK BY 3/8" CONNECTING RODS
 LOCK HANDLE LOCATED AT 42-1/2" FROM BOTTOM

INACTIVE LEAF:

2 POINT LOCK ASSEMBLY BY 'INTERLOCK USA INC.'
 1/2" DIA. BOLTS WITH 5/8" THROW AT TOP AND BOTTOM ENGAGING
 FRAME HEAD AND FRAME SILL
 THROW BOLTS ATTACHED TO LOCK BY 3/8" CONNECTING RODS
 LOCK LOCATED AT 42-1/2" FROM BOTTOM

HINGES:

4" X 4-1/2" ST. STEEL BALL BEARING HINGES BY 'REGENT/IDH'
 (3) FOR DOORS UPTO 98" HEIGHTS
 (4) FOR DOORS UPTO 120" HEIGHTS
 (5) FOR DOORS ABOVE 120" HEIGHTS
 TOP AND BOTTOM HINGES AT 6-5/8" FROM ENDS
 INTERMEDIATE HINGES EQUALLY SPACED
 FASTENED TO FRAME WITH
 (4) #12 X 1/2" FH SELF DRILLING SCREWS
 FASTENED TO LEAF WITH
 (4) #12 X 1/2" FH SELF DRILLING SCREWS

SEALANTS:

ALL JOINTS AND FRAME CONNECTIONS SEALED WITH
 WHITE/ALUMINUM COLORED SILICONE.

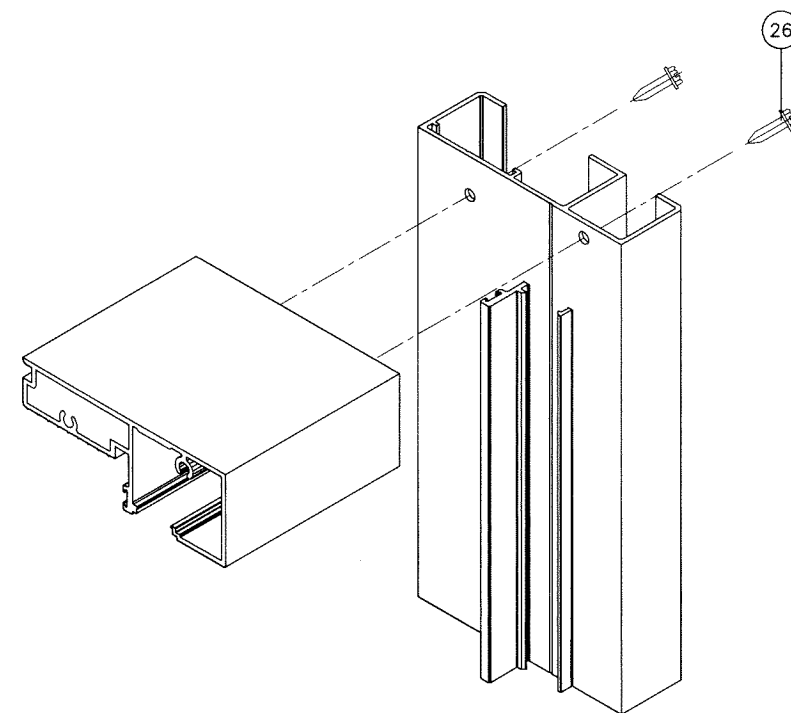

DOOR FRAME CORNER

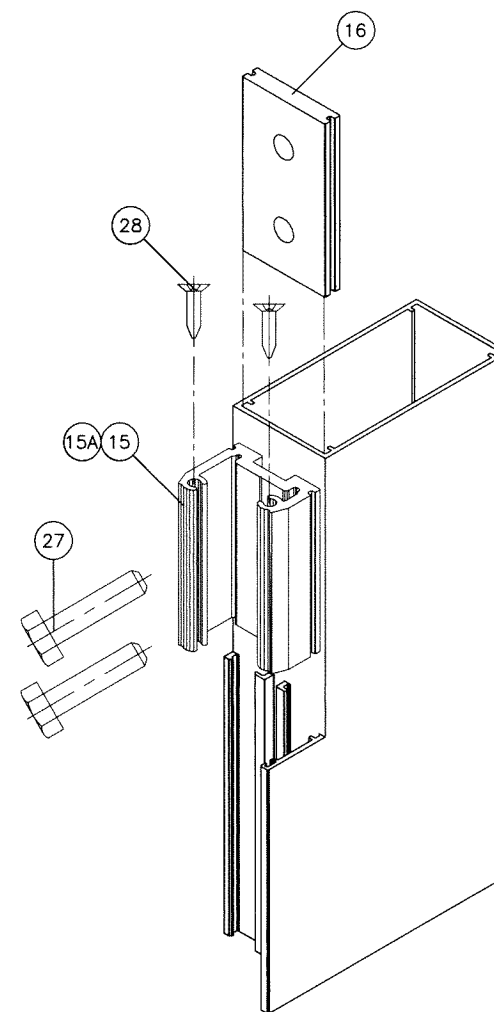

LEAF CORNER

Sealed: 7/27/2023

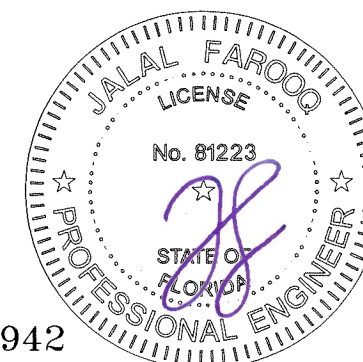

FL #26942

afc

AL-FAROOQ CORPORATION
 ENGINEERS & PRODUCT DEVELOPMENT
 9360 SUNSET DRIVE, SUITE 220
 MIAMI, FLORIDA 33173 (C.A.N. 3538)
 TEL. (305) 264-8100 FAX. (305) 262-6978

COMP-ANL\23-29F-MG

MG3500 RESIDENTIAL OUTSWING DOOR (L.M.I.)
MR-GLASS DOORS & WINDOWS MANUFACTURING, LLC
 8051 N.W. 79th Place
 Medley, FL. 33166
 Tel. (305) 764-3963 Fax. (305) 470-8285

revisions:	no	date	by	description

date: 06-26-23	scale: 3/8" = 1"	dr. by: TARIQ	chk. by:
----------------	------------------	---------------	----------

drawing no.
23-29F
 sheet 6 of 7

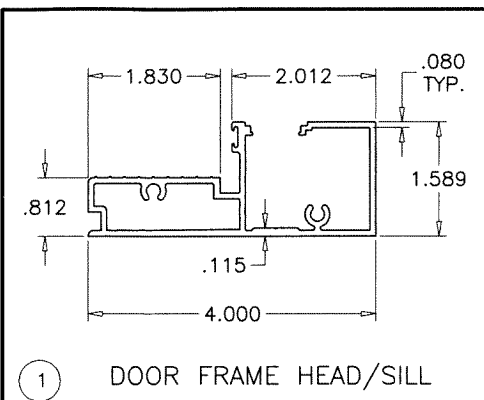

1 DOOR FRAME HEAD/SILL

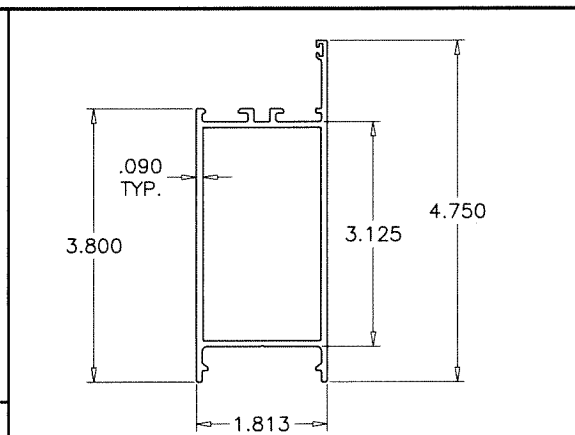

8 LEAF TOP/BOTTOM RAIL

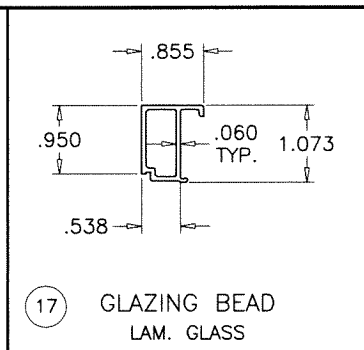

17 GLAZING BEAD LAM. GLASS

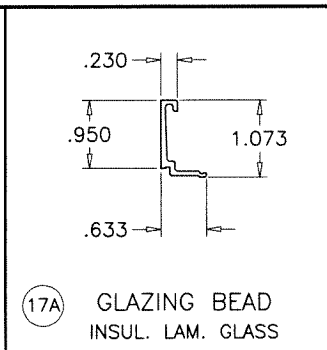

17A GLAZING BEAD INSUL. LAM. GLASS

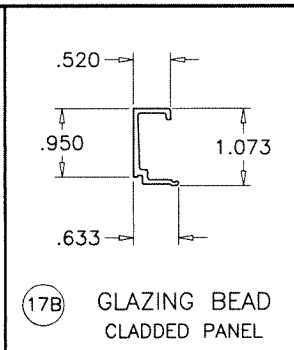

17B GLAZING BEAD CLADDED PANEL

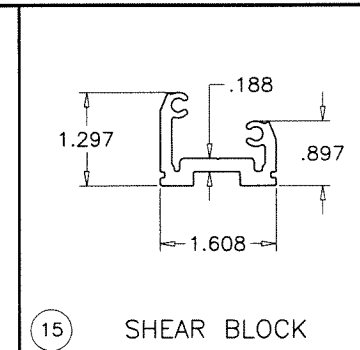

15 SHEAR BLOCK

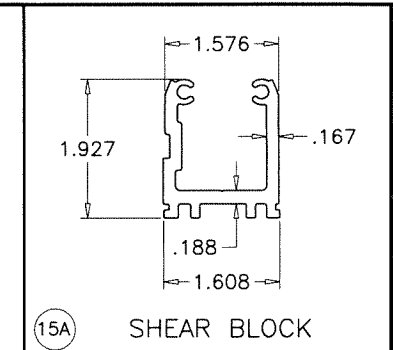

15A SHEAR BLOCK

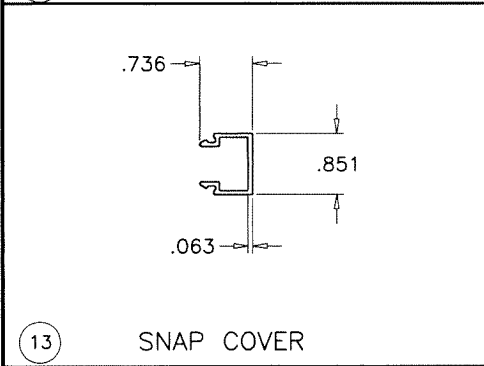

13 SNAP COVER

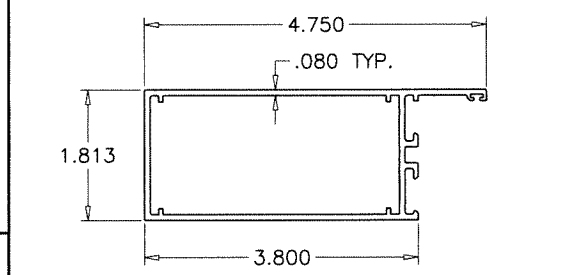

10 HINGE STILE

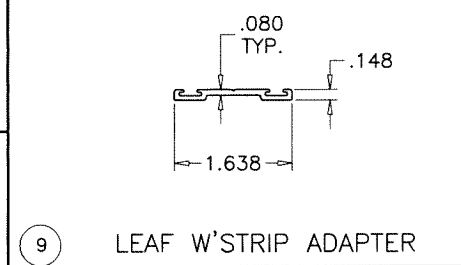

9 LEAF W'STRIP ADAPTER

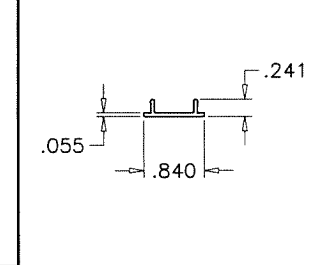

2 FRAME COVER

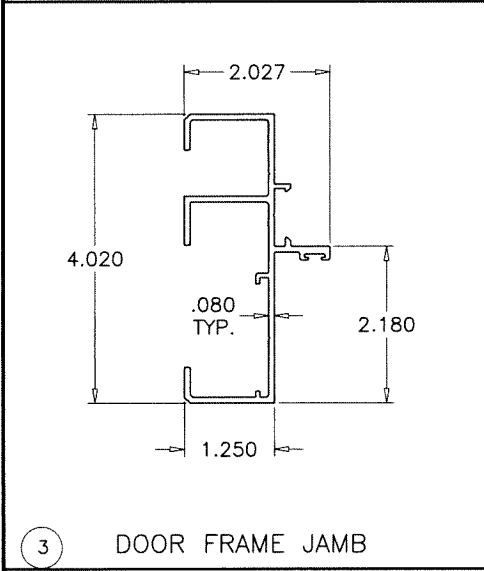

3 DOOR FRAME JAMB

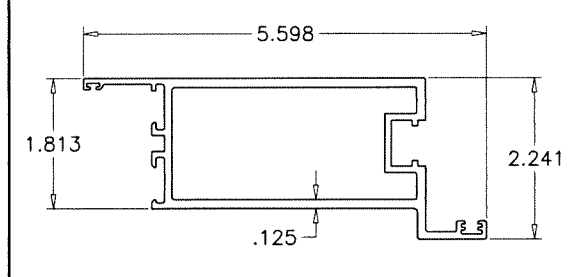

11 LOCK STILE

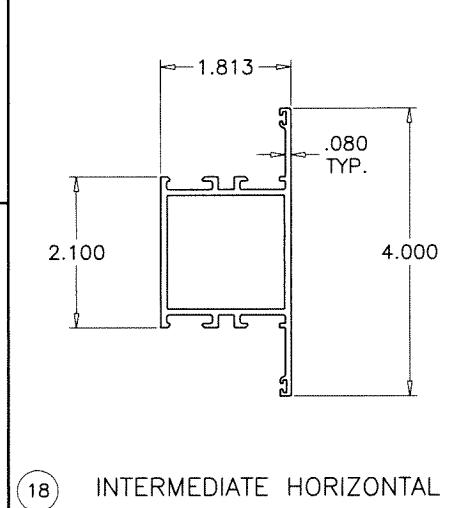

18 INTERMEDIATE HORIZONTAL

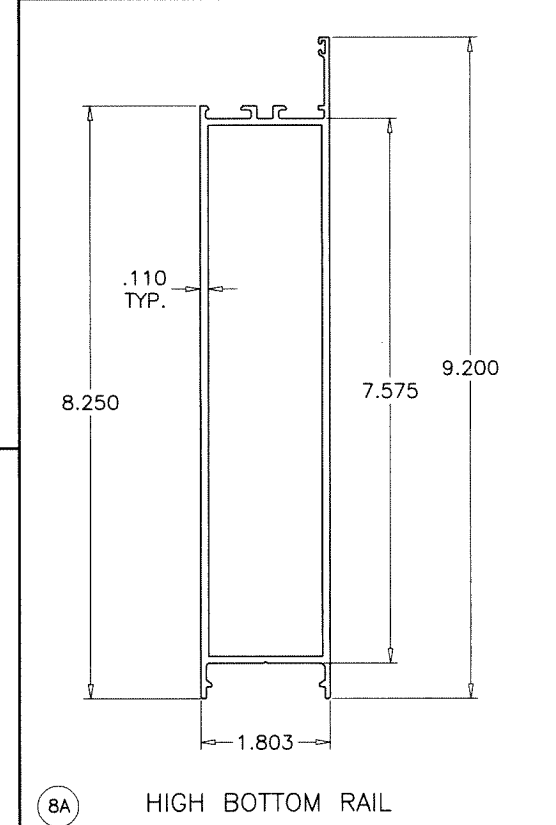

8A HIGH BOTTOM RAIL

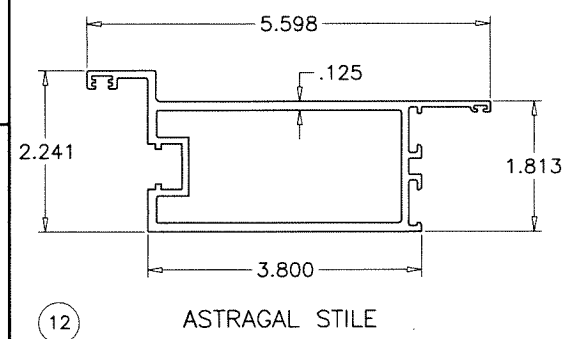

12 ASTRAGAL STILE

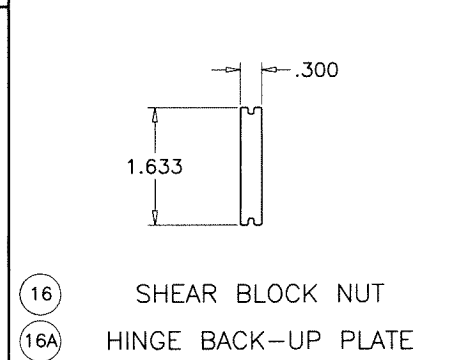

16 SHEAR BLOCK NUT

16A HINGE BACK-UP PLATE

afc
AL-FAROOQ CORPORATION
 ENGINEERS & PRODUCT DEVELOPMENT
 9360 SUNSET DRIVE, SUITE 220
 MIAMI, FLORIDA 33173 (C.A.N. 3538)
 TEL. (305) 264-8100 FAX. (305) 262-6978
 COMP-ANL\23-29F-MG

MG3500 RESIDENTIAL OUTSWING DOOR (L.M.I.)
MR-GLASS DOORS & WINDOWS MANUFACTURING, LLC
 8051 N.W. 79th Place
 Medley, FL 33166
 Tel. (305) 764-3963 Fax. (305) 470-8285

revisions:	no	date	by	description
date:	06-26-23	scale:	3/8" = 1"	
dr. by:	TARIQ	chk. by:		
drawing no.	23-29F			
sheet	7 of 7			

Sealed:7/27/2023



FL #26942